

E2 Sec. 11, T19N, R53E

01-22

Bk 08

02 01  
11 12

11 12  
14 13

EUREKA CITY LIMITS

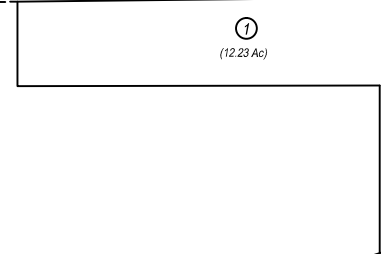
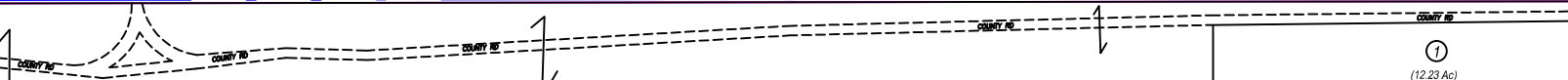

6 (151.27 Ac)

221

21

1 (4.08 Ac)

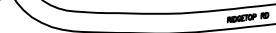

7 (12.74 Ac)

Bk 08

4 (6.62 Ac)

2 (2.10 Ac)

3 (27.55 Ac)

3 (0.64 Ac)

222

5 (83.06 Ac) BLM

4 (0.39 Ac)

EUREKA CITY LIMITS

Bk 08

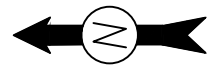

NOTE: ASSESSOR'S BLOCK NUMBERS SHOWN IN ELLIPSES.  
ASSESSOR'S PARCEL NUMBERS SHOWN IN CIRCLES.

NOTE: This plot is for assessment purposes only and does not represent a survey. No liability is assumed as to the accuracy of the data delineated hereon. Use of this plot for other than assessment purposes is forbidden unless approved by the Eureka County Assessor's Office.

Map File# 0217136

REV/EUCDAS/MAY2011/HH  
REV/EUCDAS/APR 09/HH  
REV/EUCDAS/FEB2002/HH

EUCDAS/DCT 99/HH  
SCALE: 1"=400'

EUREKA TOWNSITE

EUREKA COUNTY